

Stalpol

**Płytki zaczepowa
Nr 640.577**

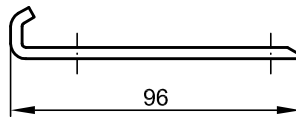
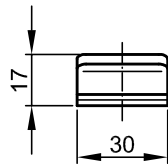

Powłoka:
- Cynkowana

tel. 52/346-41-76; fax. 52/372-62-05; www.slawpol.bydgoszcz.pl; slawpol@op.pl;

Stalpol

**Płytki zaczepowa
kryta - P/L
Nr 640.581 / 582**

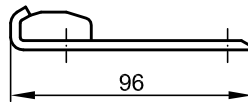
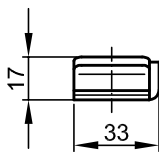

Powłoka:
- Cynkowana

tel. 52/346-41-76; fax. 52/372-62-05; www.slawpol.bydgoszcz.pl; slawpol@op.pl;